



|  |            |
|--|------------|
| Basic Specifications and Features . . . . .        | E-2        |
| Three Phase TEFC General Purpose Motors . . . . .  | E-3 to E-5 |
| Single Phase TEFC General Purpose Motors . . . . . | E-6        |
| SyMax® Permanent Magnet AC Motors . . . . .        | E-6        |
| Totally Enclosed Brakemotors . . . . .             | E-7        |
| PowerWash™ XT Washdown Motors . . . . .            | E-8        |
| PowerWash™ SXT Stainless Steel Motors . . . . .    | E-9        |
| Inverter Duty Motors . . . . .                     | E-10       |
| Permanent Magnet DC Motors . . . . .               | E-11       |
| Motor Dimensions Table . . . . .                   | E-12       |



# Electric Motors

Performance matched to Hub City™ gear drives.

## **marathon**® Motors

### Basic Specifications

- Power ratings from 1/4 to 50 hp
- 1.15 service factor
- Operating speed 1750 rpm
- Single phase or three phase design

### Standard Features

- Motors produced by Regal for high efficiency, reliability and durability
- UL recognized and CSA certified
- Ball bearings for endurance and strength
- Totally enclosed general purpose motors feature steel frames
- Brake motors feature Stearns®\* brakes, bolt-on removable bases
- Washdown motors feature USDA approved white epoxy paint, 303 stainless steel shafts, internal corrosion resistant coatings and class F insulation system
- Inverter duty motors feature encoder and brake provisions, class F insulation system, and three year warranty
- DC motors feature oversized brushes for long life, class F insulation system, and two year warranty.

\*Stearns is believed to be the trademark of Rexnord Industries, LLC and is not controlled by Regal Beloit Corporation.



### Optional Features

- Adjustable speed motor controls available
- Modified standard and custom designs
- CleanLine™ washdown and BISSC® configurations
- Unique or harsh environment adaptations
- Motor/gear drive package incentives available, consult factory

**DON'T SEE THE MOTOR YOU NEED? CONTACT FACTORY.  
MANY MORE STOCK MOTORS AVAILABLE.**

# Electric Motors

## General Purpose, Three Phase Totally Enclosed, 1800 RPM



SUITABLE FOR USE ON VFD.  
CONSULT FACTORY FOR  
GUIDELINES.

### Applications:

General purpose use on gear reducers, pumps, machine tools, and other direct-coupled equipment installed in damp, dusty, or dirty environments. Additionally, cast iron frame motors may be suitable for the process industries.

### Features:

- Ball bearings, mechanically locked on shaft end (excludes 5K models)
- Rated 60/50 hertz, 190/380 or 380 volt, at next lower horsepower (as noted)
- 1.15 Service Factor (except as noted)
- Rolled steel 56-145T frame motors accept brake kits (except as noted) consult factory.
- UL Recognized and CSA Certified

### Application Guidelines

Guidelines for Application General Purpose, Three Phase Motors on Variable Frequency Drives  
Meets NEMA MG-1-1998 Part 30 and Part 31 Section 4.4.2

| ENCLOSURE        | EFFICIENCY | FRAME  | 10:1<br>VARIABLE<br>TORQUE<br>2:1 C.T. | MAXIMUM INVERTER TO MOTOR<br>CABLE LENGTH @ 3KHZ CARRIER |        |       |
|------------------|------------|--------|--|--|--------|-------|
|                  |            |        |  | 230 V  | 460 V  | 575 V |
| Totally Enclosed | Standard   | 56-326 | X                                      | 600 ft   | 125 ft | 40 ft |

CONSULT FACTORY FOR GUIDELINES IN APPLYING EXPLOSION PROOF MOTORS ON INVERTERS.

CARRIER FREQUENCY IS MEASURED PHASE-TO-PHASE, NOT PHASE-TO-BUS. HIGHER CARRIER FREQUENCIES REQUIRE SHORTER CABLE. CONSULT FACTORY FOR DETAILS.

\*NEMA Premium is believed to be the trademark or trade name of National Electrical Manufacturers Association and is not controlled by Regal Beloit Corporation.

Don't see the motor you need?  
Contact factory  
Many more stock motors available.

### C-FACE FOOTLESS

| HP    | VOLTS       | FRAME | CAT. NO.     | NOM. EFF. | F.L. AMPS     | WEIGHT | "C" DIM. | FOOT NOTES |
|-------|-------------|-------|--------------|-----------|---------------|--------|----------|------------|
| 1/4   | 208-230/460 | 56C   | K252         | 67.4      | 1.1-1.2/0.6   | 16     | 9.52     | N,20,24,68 |
| 1/3   | 208-230/460 | 56C   | K253         | 68.8      | 1.5-1.6/0.8   | 16     | 10.60    | 24,68,111  |
| 1/2   | 208-230/460 | 56C   | K254         | 76.1      | 2.1-2.2/1.1   | 17     | 10.93    | 19,24      |
| 3/4   | 208-230/460 | 56C   | K255         | 78.9      | 2.8-2.8/1.4   | 20     | 11.36    | 19,24,68   |
| 1     | 230/460     | 56C   | <b>G527A</b> | 85.5      | 3.3/1.65      | 46     | 14.15    | A,BI,19,68 |
| 1 1/2 | 230/460     | 145TC | <b>C221B</b> | 86.5      | 4.6/2.3       | 44     | 14.71    | BI,68      |
| 2     | 230/460     | 145TC | <b>C222A</b> | 86.5      | 6.0/3.0       | 45     | 13.92    |            |
| 3     | 208-230/460 | 182TC | <b>C223C</b> | 89.5      | 8.4-7.8/3.9   | 76     | 14.47    | 13,24,68   |
| 5     | 208-230/460 | 184TC | <b>C224B</b> | 89.5      | 13.8-12.6/6.3 | 80     | 14.97    | 13,24,68   |
| 7 1/2 | 230/460     | 213TC | <b>C225C</b> | 91.7      | 19.2/9.6      | 130    | 19.46    | F,24,68    |
| 10    | 230/460     | 215TC | <b>C226B</b> | 91.7      | 26.4/13.2     | 144    | 20.96    | F,24,68    |
| 15    | 230/460     | 254TC | <b>C227B</b> | 92.4      | 37.5/18.8     | 261    | 24.02    | AL,F,24,68 |

CATALOG NUMBERS (CAT NO.) HIGHLIGHTED IN **BOLD BLUE** HAVE EFFICIENCY LEVELS THAT MEET EISA REQUIREMENTS.

#### FOOTNOTES:

- 13 F1 MOUNTING ONLY, CANNOT REASSEMBLE TO F2  
19 1.25 SERVICE FACTOR  
20 1.35 SERVICE FACTOR  
24 MOTOR WILL NOT ACCEPT A BRAKE KIT  
68 RATED 60/50 HERTZ, 190/380 OR 380 VOLT AT NEXT LOWER HORSEPOWER

111 1.30 SERVICE FACTOR

- A NEMA\*\* DESIGN A  
AL ALUMINUM FRAME CONSTRUCTION  
BI CLASS B INSULATION  
N TOTALLY ENCLOSED, NON-VENTILATED  
F CLASS F INSULATION

### 575 VOLT C-FACE FOOTLESS

| HP    | VOLTS | FRAME | CAT. NO.     | NOM. EFF. | F.L. AMPS | WEIGHT | "C" DIM. | FOOT NOTES |
|-------|-------|-------|--------------|-----------|-----------|--------|----------|------------|
| 1/4   | 575   | 56C   | K405         | 62.0      | 0.5       | 13     | 9.94     | 24         |
| 1/3   | 575   | 56C   | K522         | 71.1      | 0.6       | 16     | 10.60    | 20,24,68   |
| 1/2   | 575   | 56C   | K469         | 80.0      | 0.8       | 22     | 11.01    | 19,24,68   |
| 3/4   | 575   | 56C   | K523         | 73.4      | 1.3       | 20     | 11.36    | 19,24,68   |
| 1     | 575   | 56C   | <b>G528A</b> | 85.5      | 1.1       | 46     | 14.15    |            |
| 1 1/2 | 575   | 145TC | <b>C231B</b> | 86.5      | 1.9       | 44     | 14.71    | A,BI       |
| 2     | 575   | 145TC | <b>C232B</b> | 86.5      | 2.3       | 45     | 13.92    | A,24       |

CATALOG NUMBERS (CAT NO.) HIGHLIGHTED IN **BOLD BLUE** HAVE EFFICIENCY LEVELS THAT MEET EISA REQUIREMENTS.

#### FOOTNOTES:

- 19 1.25 SERVICE FACTOR  
20 1.35 SERVICE FACTOR

- 24 MOTOR WILL NOT ACCEPT A BRAKE KIT  
68 RATED 60/50 HERTZ, 190/380 OR 380 VOLT AT NEXT LOWER HORSEPOWER

# Electric Motors

## General Purpose, Three Phase, 1800 RPM

### Globetrotter® NEMA Premium®\* Efficiency, Totally Enclosed

#### Features

- Meets or exceeds NEMA Premium efficiencies; NEMA Premium models are in compliance with EISA2007
- Hazardous Duty™ Division 2 / Zone 2 Class 1 (gases), Groups A, B, C, D UL certification nameplate  
Temp code T2B, 182TC-449TC
- IP55 enclosure on 254TC to 449TC
- Cast iron frame and brackets
- Inverter Duty 10:1 Variable Torque and 10:1 Constant Torque, 1.0 SF (except as noted)
- 1.15 Service Factor
- Class F Insulation
- Standard assembly F1, reversible to F2 assembly
- UL Recognized, CSA Certified, CE Mark
- Three year warranty



SUITABLE FOR USE ON VFD.  
CONSULT FACTORY FOR  
GUIDELINES.

#### C-FACE FOOTED (RIGID BASE)

| HP    | VOLTS       | FRAME | CATALOG NO.    | NOM. EFF. | F.L. AMPS | WEIGHT | "C" DIM. | FOOT NOTES |
|-------|-------------|-------|----------------|-----------|-----------|--------|----------|------------|
| 1     | 208-230/460 | 143TC | <b>GT1201</b>  | 85.5      | 3.3/1.65  | 42     | 13.87    |            |
|       | 575         | 143TC | <b>GT1401</b>  | 85.5      | 1.3       | 42     | 13.87    | A          |
| 1 1/2 | 208-230/460 | 145TC | <b>GT1204</b>  | 86.5      | 4.6/2.3   | 44     | 14.37    |            |
|       | 575         | 145TC | <b>GT1404</b>  | 86.5      | 2.0       | 44     | 14.37    | A          |
| 2     | 208-230/460 | 145TC | <b>GT1207</b>  | 86.5      | 6.0/3.0   | 49     | 14.87    | A          |
|       | 575         | 145TC | <b>GT1407</b>  | 86.5      | 2.4       | 49     | 14.87    | A          |
| 3     | 208-230/460 | 182TC | <b>GT1210A</b> | 89.5      | 7.8/3.9   | 105    | 15.75    |            |
|       | 575         | 182TC | <b>GT1410A</b> | 89.5      | 3.1       | 108    | 15.75    |            |
| 5     | 208-230/460 | 184TC | <b>GT1213A</b> | 89.5      | 12.4/6.2  | 105    | 16.73    |            |
|       | 575         | 184TC | <b>GT1413A</b> | 89.5      | 5.1       | 105    | 16.73    |            |
| 7 1/2 | 230/460     | 213TC | <b>GT1216A</b> | 91.7      | 19/9.5    | 158    | 19.53    |            |
|       | 575         | 213TC | <b>GT1416A</b> | 91.7      | 7.6       | 157    | 19.53    |            |
| 10    | 230/460     | 215TC | <b>GT1219A</b> | 91.7      | 25/12.5   | 175    | 21.02    |            |
|       | 575         | 215TC | <b>GT1419A</b> | 91.7      | 10.0      | 186    | 21.02    |            |
| 15    | 208-230/460 | 254TC | <b>GT1222A</b> | 92.4      | 37.5/18.8 | 311    | 24.65    |            |
|       | 575         | 254TC | <b>GT1422A</b> | 92.4      | 15.1      | 325    | 24.65    |            |
| 20    | 208-230/460 | 256TC | <b>GT1225A</b> | 93.0      | 48.5/24.2 | 330    | 26.39    |            |
| 25    | 208-230/460 | 284TC | <b>GT1228A</b> | 93.6      | 61.0/30.5 | 500    | 26.65    | YD         |
| 30    | 208-230/460 | 286TC | <b>GT1231A</b> | 93.6      | 72.5/36.5 | 504    | 26.77    | YD         |
| 40    | 208-230/460 | 324TC | <b>GT1234A</b> | 94.1      | 95.0/47.5 | 750    | 29.69    | YD         |
| 50    | 208-230/460 | 326TC | <b>GT1237A</b> | 94.5      | 117/58.5  | 775    | 31.19    | YD         |
| 60    | 208-230/460 | 364TC | <b>GT1240A</b> | 95.0      | 138/69.0  | 1000   | 33.32    | YD         |
| 75    | 208-230/460 | 365TC | <b>GT1243A</b> | 95.4      | 171/85.5  | 1100   | 34.30    | YD         |
| 100   | 208-230/460 | 405TC | <b>GT1246A</b> | 95.4      | 226/113   | 1375   | 38.77    | YD         |

CATALOG NUMBERS (CAT NO.) HIGHLIGHTED IN **BOLD BLUE** HAVE EFFICIENCY LEVELS THAT MEET EISA REQUIREMENTS.

BLUE SHADED AREAS ARE CAST IRON FRAMES.

#### FOOTNOTES:

A NEMA DESIGN A

YD 12 LEADS FOR WYE-DELTA, PART WINDING ON LOW VOLTAGE, OR ACROSS-THE-LINE STARTING

\*NEMA Premium is believed to be the trademark or trade name of National Electrical Manufacturers Association and is not controlled by Regal Beloit Corporation.

*Don't see the motor you need?  
Contact factory.  
Many more stock motors available.*

# Electric Motors

## General Purpose, Three Phase, 1800 RPM Totally Enclosed (Four in One)

### Features

- Ball bearings, mechanically locked on shaft end (excludes 5K models)
- 1.15 Service Factor (except as noted)
- Class F insulation (except as noted)
- Rated 60/50 hertz, 190/380 or 380 volt, at next lower horsepower (as noted) 56-145T frame motors, accept brake kits, see accessory kits
- UL Recognized and CSA Certified
- Two year warranty on non bold blue catalog numbers
- Three year warranty on NEMA Premium®\* efficient (bold blue catalog numbers)



SUITABLE FOR USE ON VFD.  
CONSULT FACTORY FOR  
GUIDELINES.

### Additional Features for "4-in-1"® Motors Only

- CR200 Corona resistant magnet wire
- Bolt-on, removable rigid base
- Suitable for horizontal and vertical mounting
- Will accept drip cover kits, see Accessories section

### C-FACE FOOTED (RIGID AND REMOVABLE BASE)

| HP    | VOLTS       | FRAME | "FOUR IN-ONE" | CAT. NO.     | NOM. EFF. | F.L. AMPS      | WEIGHT | "C" DIM. | FOOT NOTES   |
|-------|-------------|-------|---------------|--------------|-----------|----------------|--------|----------|--------------|
| 1/3   | 208-230/460 | 56C   | YES           | G580         | 68.0      | 1.4-1.6/0.8    | 20     | 9.93     | N,6,13,24,68 |
|       | 575         | 56C   | YES           | K703         | 68.0      | 0.7            | 20     | 9.93     | N,6,13,24    |
| 1/2   | 208-230/460 | 56C   | YES           | G581         | 68.0      | 2.3-2.4/1.2    | 24     | 11.81    | 6,13,68      |
|       | 575         | 56C   | YES           | K705         | 68.0      | 1.0            | 23     | 11.81    | 6,13         |
| 3/4   | 208-230/460 | 56C   | YES           | G582         | 75.5      | 2.6-3.0/1.5    | 40     | 11.81    | 6,13,68      |
|       | 575         | 56C   | YES           | K707         | 75.5      | 1.2            | 24     | 11.81    | 6,13         |
| 1     | 230/460     | 56HC  | YES           | <b>G583A</b> | 85.5      | 3.3/1.65       | 42     | 14.15    | 5,6,13,68    |
|       | 575         | 56HC  | YES           | <b>K709A</b> | 85.5      | 1.3            | 42     | 14.15    | 5,6,13       |
| 1 1/2 | 230/460     | 56HC  | YES           | <b>G584A</b> | 86.5      | 4.6/2.3        | 45     | 14.65    | 5,6,13,68    |
|       | 575         | 56HC  | YES           | <b>K722A</b> | 86.5      | 1.85           | 45     | 14.65    | 5,6,13       |
| 2     | 230/460     | 56HC  | YES           | <b>G585A</b> | 86.5      | 6.0/3.0        | 48     | 15.15    | 5,6,13,68    |
|       | 575         | 56HC  | YES           | <b>K724A</b> | 86.5      | 2.4            | 38     | 15.15    | 5,6,13       |
| 3     | 208-230/460 | 182TC | YES           | <b>C382B</b> | 89.5      | 8.6-7.8/3.9    | 75     | 14.47    | 6,13,24,68   |
|       | 575         | 182TC | YES           | <b>C383B</b> | 89.5      | 3.2            | 89     | 14.97    | 6,13,24      |
| 5     | 230/460     | 184TC | YES           | <b>C386B</b> | 89.5      | 12.6/6.3       | 85     | 14.97    | 6,13,24,68   |
|       | 575         | 184TC | YES           | <b>C387B</b> | 89.5      | 5.1            | 72     | 14.97    | 6,13,24,68   |
| 7 1/2 | 208-230/460 | 213TC | YES           | <b>C390B</b> | 91.7      | 20.8-19.6/9.8  | 157    | 19.47    | 6,24,68      |
|       | 575         | 213TC | YES           | <b>C391B</b> | 91.7      | 7.9            | 157    | 19.47    | 6,24         |
| 10    | 208-230/460 | 215TC | YES           | <b>C393B</b> | 91.7      | 28.0-26.0/13.0 | 189    | 20.97    | 6,24,68      |
|       | 575         | 215TC | YES           | <b>C394A</b> | 91.7      | 10.3           | 208    | 22.22    | 6,24         |

CATALOG NUMBERS (CAT NO.) HIGHLIGHTED IN **BOLD BLUE** HAVE EFFICIENCY LEVELS THAT MEET EISA REQUIREMENTS.

#### FOOTNOTES:

- 5 56H, 143T, AND 145T COMBINATION BASE WITH 12 MOUNTING HOLES
- 6 BOLT-ON REMOVABLE BASE FOR FOOTLESS MOUNTING OPTION
- 13 F1 MOUNTING ONLY, CANNOT REASSEMBLE TO F2
- 24 MOTOR WILL NOT ACCEPT A BRAKE KIT
- 68 RATED 60/50 HERTZ, 190/380 OR 380 VOLT AT NEXT LOWER HORSEPOWER
- N TOTALLY ENCLOSED, NON-VENTILATED

\*NEMA Premium is believed to be the trademark or trade name of National Electrical Manufacturers Association and is not controlled by Regal Beloit Corporation.

Don't see the motor you need?  
Contact factory  
Many more stock motors available.

# Electric Motors

## General Purpose, Single Phase, 1800 RPM, Totally Enclosed

### Features

- Ball bearings mechanically locked on shaft end (excludes 5K models)
- Heavy gauge steel constructions
- Suitable for horizontal or vertical mounting
- Economical split phase or capacitor start designs, as noted
- Service factor, as noted
- UL recognized and CSA certified



### C-FACE FOOTLESS

| HP    | VOLTS       | FRAME | OVER LOAD | CAT. NO. | F.L. AMPS    | WEIGHT | "C" DIM. | FOOT NOTES |
|-------|-------------|-------|-----------|----------|--------------|--------|----------|------------|
| 1/6   | 115         | 56C   | NONE      | H244     | 4.0          | 10     | 10.30    | 3,17,24    |
| 1/4   | 115/230     | 56C   | NONE      | G1511    | 5.4/2.7      | 16     | 10.30    | 2,17,24    |
| 1/3   | 115/230     | 56C   | NONE      | G1513    | 6.0/3.0      | 19     | 10.93    | 2,18,24    |
| 1/2   | 115/230     | 56C   | AUTO      | C446     | 8.6/4.3      | 21     | 11.01    | 2,18,24    |
|       | 115/230     | 56C   | NONE      | G1515    | 8.6/4.3      | 21     | 11.01    | 2,18,24    |
| 3/4   | 115/230     | 56C   | NONE      | G1517    | 11.0/5.5     | 31     | 11.84    | 2,17,24    |
| 1     | 115/230     | 56C   | NONE      | G1519    | 13.2/6.6     | 36     | 12.97    | 2,17,24    |
| 1 1/2 | 115/208-230 | 56C   | NONE      | G1531    | 14.5/7.1-7.3 | 44     | 13.69    | ES,1,18,24 |

### FOOTNOTES:

- 1 CAPACITOR START/CAPACITOR RUN DESIGN FOR REDUCED AMPERAGE
- 2 CAPACITOR START INDUCTION RUN DESIGN
- 3 SPLIT PHASE DESIGN
- 17 1.0 SERVICE FACTOR
- 18 1.15 SERVICE FACTOR
- 24 MOTOR WILL NOT ACCEPT A BRAKE KIT
- ES ENERGY SAVER DESIGN

## SyMax® Permanent Magnet AC Motors, TENV & TEFC Three Phase, 1800 RPM



### Features

- High power density, low weight design
- Provisions for optional "BCP" (Bearing Current Protection)
- Three year warranty
- Requires drive for operation



### Additional Features for Commercial, Rolled Steel Frame (NEMA 56 frame models)

- Meets or exceeds NEMA Premium®\* (IE3)
- Class F MAX GUARD® insulation system
- Operational to 20:1 constant torque open-loop (1000:1 closed-loop)
- IP43 ingress protection
- Totally enclosed, non-ventilated
- Sealed ball bearing

### Additional Features for Industrial, Cast Iron frame (NEMA 182-286T frame models)

- Ultra Efficient™ Premium-Plus exceeds NEMA Premium® (IE4)
- Class H MAX GUARD® insulation system
- Cast iron construction for rigidity & reduced vibration
- IP54 ingress protection
- Premium severe duty
- Normally closed thermostats (one per phase, Class F)
- UL, CSA and CE Mark

| HP    | VOLTS   | NEMA FRAME | TORQUE (LB-FT) | CAT. NO.      | NOM. EFF. | F.L. AMPS | WEIGHT | "C" DIM. | FOOT NOTES |
|-------|---------|------------|----------------|---------------|-----------|-----------|--------|----------|------------|
| 1/2   | 230/460 | 56C        | 1.5            | <b>SY001</b>  | 83.5      | 1.86/0.93 | 13     | 7.68     | N          |
| 1     | 230/460 | 56C        | 2.9            | <b>SY003</b>  | 85.3      | 3.55/1.78 | 18     | 8.68     | N          |
| 1 1/2 | 230/460 | 56C        | 4.4            | <b>SY004</b>  | 86.1      | 5.48/2.74 | 23     | 9.68     | N          |
| 2     | 230/460 | 56C        | 5.8            | <b>SY005</b>  | 86.5      | 6.32/3.16 | 28     | 10.68    | N          |
| 3     | 230/460 | 182TC      | 8.8            | <b>SY006A</b> | 91.7      | 6.6/3.3   | 99     | 17.5     | N          |
| 5     | 230/460 | 184TC      | 11.7           | <b>SY007A</b> | 92.4      | 5.1/2.6   | 143    | 17.5     | N          |
| 7 1/2 | 230/460 | 213TC      | 21.9           | <b>SY008A</b> | 92.4      | 18.2/9.1  | 152    | 20.41    | N          |
| 10    | 230/460 | 215TC      | 29.2           | <b>SY009A</b> | 94.5      | 24.7/12.4 | 166    | 20.41    | N          |
| 15    | 460     | 254TC      | 43.8           | <b>SY010</b>  | 94        | 18        | 392    | 25.68    |            |
| 20    | 460     | 256TC      | 58.4           | <b>SY011</b>  | 94.5      | 24        | 386    | 25.68    |            |
| 25    | 460     | 284TC      | 72.9           | <b>SY012</b>  | 94.5      | 30        | 408    | 26.21    |            |
| 30    | 460     | 286TC      | 87.5           | <b>SY013</b>  | 95.4      | 35.5      | 456    | 27.71    |            |

### FOOTNOTES:

- N TOTALLY ENCLOSED, NON-VENTILATED

CATALOG NUMBERS (CAT NO.) HIGHLIGHTED IN **BOLD BLUE** HAVE EFFICIENCY LEVELS THAT MEET EISA REQUIREMENTS.

BLUE SHADED AREAS ARE CAST IRON FRAMES.

\*NEMA Premium is believed to be the trademark or trade name of National Electrical Manufacturers Association and is not controlled by Regal Beloit Corporation.

### Single Phase, 1800 RPM, Totally Enclosed, C-Face Footed (Removable Base)

#### Features

- Fail-safe, spring set Stearns\* 56 Series brake for holding or stopping
- Brake has manual wear adjustment for longer pad life
- Manual release lever on rear of brake housing
- Brake leads are terminated at the brake
- Universal mounting, no modifications needed
- Brake coil voltage matches motor voltages
- Ball bearings, mechanically locked on shaft end
- 1.15 service factor (1.0 service factor as noted)
- Nameplated 60/50 hertz at next lowest horsepower
- UL recognized and CSA certified



| HP    | VOLTS       | FRAME | CATALOG NO. | F.L. AMPS    | WEIGHT | "C" DIM. | BRAKE RATING (lb/ft) | FOOT NOTES |
|-------|-------------|-------|-------------|--------------|--------|----------|----------------------|------------|
| 1/3   | 115/208-230 | 56C   | D400        | 6.6/3.1-3.3  | 33     | 16.20    | 3                    | 2,6        |
| 1/2   | 115/208-230 | 56C   | D401        | 8.8/4.2-4.4  | 34     | 16.20    | 3                    | 2,6        |
| 3/4   | 115/208-230 | 56C   | D402        | 11.0/5.4-5.5 | 38     | 16.70    | 6                    | 2,6        |
| 1     | 115/208-230 | 56C   | D403        | 13.4/6.8-6.7 | 40     | 17.20    | 6                    | 2,6        |
| 1 1/2 | 115/208-230 | 56C   | D404        | 15.2/8.2-7.6 | 50     | 19.04    | 10                   | 1,6        |

#### FOOTNOTES:

- 1 CAPACITOR START/CAPACITOR RUN DESIGN FOR REDUCED AMPERAGE
- 2 CAPACITOR START INDUCTION RUN DESIGN
- 6 BOLT-ON REMOVABLE BASE FOR FOOTLESS MOUNTING OPTION

### Three Phase, 1800 RPM, Totally Enclosed, C-Face Footed (Rigid or Removable Base)

#### Features

- **In addition to the Single Phase Features above:**
- Brake has manual wear adjustment up to 25 lb-ft. for longer pad life
- Stearns brakes, 56 series through 25 Lb-Ft, 87 series above 35 Lb-Ft and larger
- Brake leads routed through motor conduit box (TENV only)
- Universal mounting up to 15 Lb-Ft, C406 has vertical springs included
- CR<sup>200</sup> Corona resistant magnet wire (motor can be operated 10:1 variable torque and 2:1 constant torque)
- 1.15 service factor, 1.0 service factor where footnoted



SUITABLE FOR USE ON VFD.  
CONSULT FACTORY FOR  
GUIDELINES.

| HP    | VOLTS       | FRAME | CAT. NO.     | F.L. AMPS   | WEIGHT | "C" DIM. | BRAKE RATING (lb/ft) | FOOT NOTES |
|-------|-------------|-------|--------------|-------------|--------|----------|----------------------|------------|
| 1/3   | 208-230/460 | 56C   | <b>D450</b>  | 1.8-1.6/0.8 | 30     | 15.73    | 3                    | 6          |
| 1/2   | 208-230/460 | 56C   | <b>D452</b>  | 2.3-2.4/1.2 | 32     | 16.23    | 3                    | 6          |
| 3/4   | 208-230/460 | 56C   | <b>D454</b>  | 2.9-3.0/1.5 | 33     | 16.23    | 6                    | 6          |
| 1     | 230/460     | 56C   | <b>D456A</b> | 3.3/1.7     | 85     | 18.81    | 6                    | 6          |
| 1 1/2 | 230/460     | 56HC  | <b>D457A</b> | 4.6/2.3     | 48     | 18.72    | 10                   | 6          |
|       | 230/460     | 145TC | <b>C401A</b> | 4.6/2.3     | 62     | 18.76    | 10                   | 6          |
| 2     | 230/460     | 145TC | <b>C403A</b> | 6.0/3.0     | 62     | 18.77    | 10                   | 6          |
| 7 1/2 | 230/460     | 213TC | <b>C407A</b> | 19.2/9.6    | 200    | 27.64    | 35                   | AL,F,N,17  |
| 10    | 230/460     | 215TC | <b>C408</b>  | 25.0/12.5   | 211    | 28.64    | 50                   | AL,F,N,17  |

#### FOOTNOTES:

- 6 BOLT-ON REMOVABLE BASE FOR FOOTLESS MOUNTING OPTION
- 17 1.0 SERVICE FACTOR
- 82 WELDED RIGID BASE
- AL ALUMINUM FRAME CONSTRUCTION
- F CLASS F INSULATION
- N TOTALLY ENCLOSED, NON-VENTILATED

*Don't see the motor you need?  
Contact factory.  
Many more stock motors available.*

\*Stearns is believed to be the trademark of Rexnord Industries, LLC and is not controlled by Regal Beloit Corporation.



# Electric Motors

## Powerwash™ XT Washdown Duty, 1800 RPM White Epoxy, Totally Enclosed

### Features

- Double sealed ball bearings
- 303 Stainless steel shaft with spring loaded contact seals in each endshield (drive end only on TENV motors)
- Stainless steel conduit box cover, nameplate, fan guard (TEFC) and hardware
- Cast oversized conduit box with high temperature nitrile gaskets and threaded entrance
- Plugged drain holes in each endshield for all angle mounting
- Internal corrosion resistant coatings on frame, base, endshields, rotor and stator
- USDA-approved, white epoxy RUST-OLEUM® \* paint
- UL Recognized, CSA Certified and CE Mark
- Encapsulated electronic starting switch is impervious to moisture (single phase only)
- Capacitor start induction run design for high starting torque unless otherwise noted (single phase only)
- Class F insulation (single phase only)
- 1.15 service factor (single phase only)
- 1.15 service factor on sinewave, 1.0 service factor on IGBT power (three phase only)



**IP55**

### SINGLE PHASE • C-FACE FOOTLESS

| HP    | VOLTS       | FRAME | CATALOG NO. | F.L. AMPS    | WEIGHT | "C" DIM. | FOOT NOTES |
|-------|-------------|-------|-------------|--------------|--------|----------|------------|
| 1/3   | 115/208-230 | 56C   | N531        | 6.4/3.2-3.2  | 23     | 10.69    |            |
| 1/2   | 115/208-230 | 56C   | N523        | 8.8/4.4-4.4  | 26     | 11.19    |            |
| 3/4   | 115/208-230 | 56C   | N525        | 10.8/5.4-5.4 | 31     | 11.69    |            |
| 1     | 115/208-230 | 56C   | N527        | 12.8/6.4-6.4 | 33     | 12.19    |            |
| 1 1/2 | 115/208-230 | 56C   | N529        | 19.0/9.5-9.5 | 23     | 13.69    |            |

### THREE PHASE • C-FACE FOOTLESS

| HP    | VOLTS       | FRAME | CATALOG NO.  | NOM. EFF. | F.L. AMPS    | WEIGHT | "C" DIM. | FOOT NOTES |
|-------|-------------|-------|--------------|-----------|--------------|--------|----------|------------|
| 1/4   | 208-230/460 | 56C   | N640         | 68.0      | 1.1-1.1/55   | 21     | 9.56     | N          |
| 1/3   | 208-230/460 | 56C   | N641         | 72.0      | 1.3-1.3/65   | 21     | 9.56     | N          |
| 1/2   | 208-230/460 | 56C   | N642         | 78.5      | 1.8-1.8/9    | 25     | 10.06    | N          |
| 3/4   | 208-230/460 | 56C   | N644         | 80.0      | 2.5-2.5/1.25 | 30     | 10.56    | N          |
| 1     | 230/460     | 56C   | <b>N646A</b> | 85.5      | 3.1/1.55     | 50     | 12.87    | V          |
|       | 230/460     | 143TC | <b>N647A</b> | 85.5      | 3.2/1.6      | 38     | 12.72    | V          |
| 1 1/2 | 230/460     | 143TC | <b>N650A</b> | 86.5      | 4.8/2.4      | 57     | 13.22    | V          |
| 2     | 230/460     | 145TC | <b>N654B</b> | 86.5      | 5.8/2.9      | 45     | TBD      | V          |
| 3     | 230/460     | 182TC | <b>N656C</b> | 89.5      | 7.8/39       | 79     | 14.47    | V          |
| 5     | 230/460     | 184TC | <b>N658C</b> | 89.5      | 12.6/6.3     | 108    | 14.97    | V          |



SUITABLE FOR USE ON VFD. CONSULT FACTORY FOR GUIDELINES.

CATALOG NUMBERS (CAT NO.) HIGHLIGHTED IN **BOLD BLUE** HAVE EFFICIENCY LEVELS THAT MEET EISA REQUIREMENTS.

#### FOOTNOTES:

- 13 F1 MOUNTING ONLY, CANNOT REASSEMBLE TO F2
- N TOTALLY ENCLOSED, NON-VENTILATED
- V SUITABLE FOR 10:1 CT 60 MINUTE DUTY, OTHERWISE 2:1 CT

*Don't see the motor you need?  
Contact factory.  
Many more stock motors available.*



**IP55**



\*Rust-Oleum is believed to be the trademark or trade name of Rust-Oleum Corporation and is not controlled by Regal Beloit Corporation.



# Electric Motors

## Powerwash™ SXT Washdown Duty, 1800 RPM All Stainless Steel, Totally Enclosed

### Features

- Double sealed ball bearings
- 303 stainless steel shaft with spring loaded contact seals in each end. (Drive end only on TENV)
- 300 Series Stainless steel external construction: frame, endshields, conduit box, mounting base and hardware for superior corrosion resistance
- Internal corrosion resistant coatings on rotor and heavy polyester varnish on the stator
- 100% Paint-free construction
- One way condensation drains in each endshield and conduit box for all angle mounting
- Nitrile Buna - N gaskets and seals on conduit box, through bolts and endshields
- Nameplate information laser etched on frame
- UL recognized, CSA certified and CE mark
- Encapsulated electronic starting switch is impervious to moisture (single phase only)
- Capacitor start induction run design for high starting torque unless otherwise noted (single phase only)
- Suitable for use on VFD 10:1 variable torque, 10:1 (TEFC) or 1000:1 (TENV) constant torque (3 phase only)
- MAX GUARD® Class F insulation system (3 phase only)
- 1.15 Service Factor on sinewave, 1.0 Service Factor on IGBT power (3 phase only)
- Rated 60/50 hertz, 190/380 volt at next lower horsepower (3 phase only)



SUITABLE FOR USE ON VFD.  
CONSULT FACTORY FOR  
GUIDELINES.



### SINGLE PHASE • C-FACE FOOTED (RIGID BASE)

| HP    | VOLTS       | FRAME | CATALOG NO. | F.L. AMPS | WEIGHT | "C" DIM. | FOOT NOTES |
|-------|-------------|-------|-------------|-----------|--------|----------|------------|
| 1/2   | 115/208-230 | 56C   | N341        | 8.2/4.1   | 31.5   | 11.10    |            |
| 3/4   | 115/208-230 | 56C   | N343        | 9.8/4.9   | 39.0   | 11.80    |            |
| 1     | 115/208-230 | 56C   | N345        | 13.6/6.8  | 42.5   | 12.30    |            |
| 1 1/2 | 115/208-230 | 56C   | N347        | 15.8/7.9  | 52.5   | 13.20    |            |
| 2     | 115/208-230 | 145TC | N349        | 16.4/8.2  | 64.5   | 14.20    |            |

### THREE PHASE • C-FACE FOOTLESS

| HP    | VOLTS       | FRAME | CATALOG NO.  | NOM. EFF. | F.L. AMPS    | WEIGHT | "C" DIM. | FOOT NOTES |
|-------|-------------|-------|--------------|-----------|--------------|--------|----------|------------|
| 1/3   | 208-230/460 | 56C   | N430         | 78.5      | 1.2-1.3/1.65 | 30     | 9.78     | N          |
| 1/2   | 208-230/460 | 56C   | N431         | 81.5      | 1.5-1.6/1.8  | 33     | 9.78     | N          |
| 3/4   | 208-230/460 | 56C   | N432         | 82.5      | 2.4-2.3/1.2  | 38     | 9.78     | N          |
| 1     | 208-230/460 | 56C   | <b>N433A</b> | 85.5      | 3.2-3.0/1.5  | 55     | 13.77    |            |
|       | 208-230/460 | 143TC | <b>N434B</b> | 85.5      | 3.2-3.0/1.5  | 55     | 13.62    |            |
| 1 1/2 | 208-230/460 | 56C   | <b>N435A</b> | 86.5      | 4.2-3.8/1.9  | 56     | 13.77    |            |
|       | 208-230/460 | 145TC | <b>N436A</b> | 86.5      | 4.8-4.4/2.2  | 56     | 13.62    |            |
| 2     | 208-230/460 | 56C   | <b>N437A</b> | 86.5      | 5.8-5.4/2.7  | 59     | 13.77    |            |
|       | 208-230/460 | 145TC | <b>N438B</b> | 86.5      | 5.8-5.4/2.7  | 59     | 13.62    |            |

CATALOG NUMBERS (CAT NO.) HIGHLIGHTED IN **BOLD BLUE** HAVE EFFICIENCY LEVELS THAT MEET EISA REQUIREMENTS.

FOOTNOTES:

N TOTALLY ENCLOSED, NON-VENTILATED

*Don't see the motor you need?  
Contact factory.  
Many more stock motors available.*

# Electric Motors

## Inverter (Vector) Duty: Black Max®, 1800 RPM 1000:1 Contact Torque, TENV, Three Phase Motors

### Applications:

Designed for inverter or vector applications where up to a 1000:1 constant torque speed range is required. Typical uses include: material handling, machine tools, conveyors, crane and hoist, metal processing, test stands, pumps compressors, textile processing, and other industrial machinery installed in dusty or dirty environments.

### Features:

- MAX GUARD® Class F insulation system
- Constant torque operation from 0 to base speed on vector drive
- Constant horsepower operation up to twice base RPM
- Continuous duty at 40°C ambient
- Optimized for operation with IGBT inverter (NEMA Design A)
- Normally closed thermostats (one per phase, Class F)
- Removable rigid base, as noted
- Ball bearings
- Field reversible to F2 (except as noted)
- Encoder and brake provisions included on opposite drive end (maximum 10 lb-ft brake)
- UL recognized, CSA certified, and CE mark
- Three year warranty



SUITABLE FOR USE ON VFD. CONSULT FACTORY FOR GUIDELINES.



### C-FACE FOOTED (RIGID BASE)

| HP    | VOLTS   | FRAME | OVER LOAD | CAT. NO. | F.L. AMPS | WEIGHT | "C" DIM. | FOOT NOTES |
|-------|---------|-------|-----------|----------|-----------|--------|----------|------------|
| 1/4   | 230/460 | 56C   | TSTAT     | Y592     | 1.2/0.6   | 19     | 11.88    | S,13       |
| 1/2   | 230/460 | 56C   | TSTAT     | Y534     | 1.6/0.8   | 35     | 13.48    | S,6,13     |
|       | 575     | 56C   | TSTAT     | Y555     | 0.6       | 35     | 13.48    | S,6,13     |
| 1     | 230/460 | 56C   | TSTAT     | Y535     | 3.0/1.5   | 39     | 14.98    | S,6,13     |
|       | 575     | 56C   | TSTAT     | Y556     | 1.2       | 39     | 14.98    | S,6,13     |
|       | 230/460 | 143TC | TSTAT     | Y536     | 3.0/1.5   | 48     | 15.04    | S,6,13     |
| 1 1/2 | 230/460 | 145TC | TSTAT     | Y538     | 4.8/2.4   | 50     | 16.04    | S,6,13     |
|       | 230/460 | 145TC | TSTAT     | Y612     | 6.0/3.0   | 65     | 16.04    | S,6,13     |
| 2     | 230/460 | 145TC | TSTAT     | Y551     | 6.0/3.0   | 73     | 14.68    |            |
|       | 575     | 145TC | TSTAT     | Y611     | 2.4       | 65     | 16.04    | S,6,13     |
|       | 575     | 145TC | TSTAT     | Y557     | 2.4       | 73     | 14.68    |            |
| 3     | 230/460 | 182TC | TSTAT     | Y541A    | 8.2/4.1   | 95     | 16.19    | AL         |
|       | 575     | 182TC | TSTAT     | Y558A    | 3.4       | 95     | 16.19    | AL         |
| 5     | 230/460 | 184TC | TSTAT     | Y543A    | 13.4/6.7  | 110    | 17.69    | AL         |
|       | 575     | 184TC | TSTAT     | Y559A    | 5.4       | 110    | 17.69    | AL         |
| 7 1/2 | 230/460 | 213TC | TSTAT     | Y545     | 21.0/10.5 | 146    | 20.54    | AL         |
|       | 575     | 213TC | TSTAT     | Y560     | 8.4       | 146    | 20.54    | AL         |
| 10    | 230/460 | 215TC | TSTAT     | Y547     | 27.0/13.5 | 219    | 23.04    | AL         |
|       | 575     | 215TC | TSTAT     | Y561     | 10.8      | 219    | 23.04    | AL         |
| 15    | 230/460 | 254TC | TSTAT     | Y549     | 40.0/20.0 | 260    | 26.87    | AL,I       |
|       | 575     | 254TC | TSTAT     | Y562     | 16.0      | 260    | 26.87    | AL,I       |
| 20    | 230/460 | 256TC | TSTAT     | Y552     | 52.0/26.0 | 300    | 27.13    |            |
|       | 575     | 256TC | TSTAT     | Y563     | 20.8      | 300    | 27.13    |            |
| 25    | 230/460 | 284TC | TSTAT     | Y553     | 62.0/31.0 | 379    | 27.08    | I          |
|       | 575     | 284TC | TSTAT     | Y567     | 24.8      | 379    | 27.08    | I          |
| 30    | 230/460 | 286TC | TSTAT     | Y393     | 74.0/37.0 | 575    | 28.58    | I          |
|       | 575     | 286TC | TSTAT     | Y394     | 29.6      | 575    | 28.58    | I          |

#### FOOTNOTES:

- 6 BOLT-ON REMOVABLE BASE FOR FOOTLESS MOUNTING OPTION
- 13 F1 MOUNTING ONLY, CANNOT REASSEMBLE TO F2
- I REDUCED HP @ 120 HZ
- S STEEL FRAME CONSTRUCTION
- AL ALUMINUM FRAME CONSTRUCTION

BLUE SHADED AREAS ARE CAST IRON FRAMES.

# Electric Motors

## DC Permanent Magnet, 1750 RPM SCR Rated, Totally Enclosed

### C-Face Footed (Removable Base)

#### Features

- Class F insulation
- NEMA C-Face with removable rigid base
- Oversized brushes for extra long life
- Permanently lubricated sealed ball bearings
- Linear speed/torque characteristics over entire speed range
- High starting torque, high peak current capability
- Usable on PWM type DC adjustable speed drives at higher HP rating
- Easy brush access with unique brush holder design
- UL recognized and CSA certified



| HP    | DC VOLTS | FRAME     | ENCL. | CAT. NO. | C.T. SPEED RANGE | F.L. AMPS | PWM HP RATING | WEIGHT | "C" DIM. | FOOT NOTES |
|-------|----------|-----------|-------|----------|------------------|-----------|---------------|--------|----------|------------|
| 1/4   | 90       | 56C       | TEFC  | Z602     | 2:1              | 2.5       | 0.40          | 22     | 10.81    |            |
|       | 180      | 56C       | TEFC  | Z603     | 2:1              | 1.4       | 0.50          | 22     | 11.31    |            |
| 1/3   | 90       | 56C       | TEFC  | Z604     | 2:1              | 3.5       | 0.50          | 24     | 11.31    |            |
| 1/2   | 90       | 56C       | TEFC  | Z606     | 2:1              | 5.0       | 0.70          | 26     | 11.81    |            |
|       | 180      | 56C       | TEFC  | Z607     | 2:1              | 2.5       | 0.56          | 25     | 11.81    |            |
| 3/4   | 90       | 56C       | TEFC  | Z610     | 2:1              | 7.6       | 1.00          | 34     | 13.81    |            |
|       | 180      | 56C       | TEFC  | Z611     | 2:1              | 3.8       | 1.00          | 34     | 13.81    |            |
| 1     | 90       | 56C       | TEFC  | Z612     | 2:1              | 10.0      | 1.25          | 45     | 14.81    |            |
|       | 180      | 56C       | TEFC  | Z613     | 2:1              | 5.0       | 1.25          | 41     | 14.81    |            |
| 1 1/2 | 180      | 56C       | TEFC  | Z614     | 2:1              | 7.6       | 1.75          | 52     | 16.81    |            |
|       | 180      | 145TC     | TEFC  | Z615     | 2:1              | 7.5       | 1.50          | 74     | 18.34    |            |
| 2     | 180      | 145TC     | TEFC  | Z616     | 2:1              | 9.5       | 2.00          | 86     | 19.34    |            |
|       | 180      | 182/145TC | TEFC  | Z617     | 2:1              | 9.5       | 2.00          | 83     | 19.34    | 84         |

#### FOOTNOTES:

84 NEMA 145T C-FACE MOUNTING WITH REMOVABLE 182T RIGID BASE

### Washdown

#### Features

- Class F insulation
- NEMA C-Face with removable rigid base
- Oversized brushes for extra long life
- Doubled sealed, oversized ball bearings
- Corrosion resistant 303 stainless steel shaft
- "V" ring Forsheda\* seals
- High temperature, moisture resistant lubricant
- Exterior and interior components protected with enamel & polyester compounds
- Aluminum conduit box, threaded and gasketed
- Drains at 3:00, 6:00, 9:00 and 12:00 locations
- Sealed machine fits
- Stainless steel nameplate
- USDA approved white epoxy paint
- UL recognized and CSA certified

| HP    | DC VOLTS | FRAME | ENCL. | CAT. NO. | C.T. SPEED RANGE | F.L. AMPS | PWM HP RATING | WEIGHT | "C" DIM. | FOOT NOTES |
|-------|----------|-------|-------|----------|------------------|-----------|---------------|--------|----------|------------|
| 1/4   | 90       | 56C   | TENV  | Z630     | 20:1             | 2.7       | 0.30          | 24     | 10.69    |            |
| 1/3   | 90       | 56C   | TENV  | Z631     | 20:1             | 3.5       | 0.56          | 30     | 11.69    |            |
| 1/2   | 90       | 56C   | TENV  | Z634     | 20:1             | 4.9       | 0.75          | 37     | 13.69    |            |
| 3/4   | 90       | 56C   | TENV  | Z636     | 20:1             | 7.0       | 1.25          | 51     | 14.67    |            |
|       | 180      | 56C   | TENV  | Z637     | 20:1             | 3.5       | 1.25          | 50     | 14.17    |            |
| 1     | 90       | 56C   | TEFC  | Z638     | 2:1              | 10.0      | 1.25          | 45     | 14.81    |            |
|       | 180      | 56C   | TEFC  | Z639     | 2:1              | 5.0       | 1.25          | 41     | 14.81    |            |
| 1 1/2 | 180      | 56C   | TEFC  | Z641     | 2:1              | 7.6       | 1.75          | 51     | 16.81    |            |



\*Forsheda is believed to be the trademark of Trelleborg Forsheda Building AB and is not controlled by Regal Beloit Corporation.

# Electric Motors

TYPICAL C-FACE MOTOR

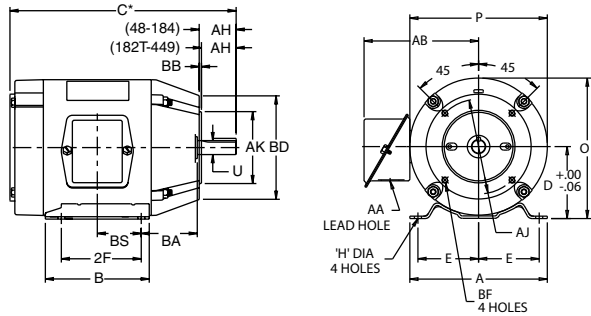

TYPICAL RIGID BASE MOTOR

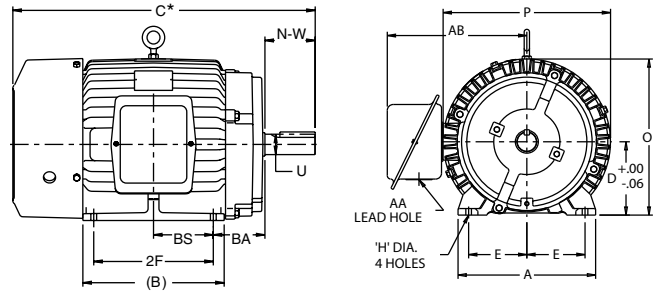

| FRAME | D    | E    | 2F    | H        | O (MAX) | P (MAX) | U      | N-W  | AA    | AB (MAX) | AH   | AJ     | AK     | BA   | BB (MIN) | BD (MAX) | BF     |
|-------|------|------|-------|----------|---------|---------|--------|------|-------|----------|------|--------|--------|------|----------|----------|--------|
| 48    | 3.00 | 2.12 | 2.75  | .34 SLOT | 5.83    | 5.66    | .5000  | 1.50 | 1/2   | -        | 1.69 | 3.750  | 3.000  | 2.50 | .16      | 5.62     | 1/4-20 |
| 56    | 3.50 | 2.44 | 3.00  | .34 SLOT | 6.32    | 5.66    | .6250  | 1.88 | 1/2   | -        | 2.06 | 5.875  | 4.500  | 2.75 | .16      | 6.50     | 3/8-16 |
| 56H   | 3.50 | 2.44 | 5.00  | .34 SLOT | 6.74    | 6.48    | .6250  | 1.88 | 1/2   | -        | 2.06 | 5.875  | 4.500  | 2.75 | .16      | 6.50     | 3/8-16 |
| 143T  | 3.50 | 2.75 | 4.00  | .34      | 7.45    | 7.75    | .8750  | 2.25 | 3/4   | 7.04     | 2.12 | 5.875  | 4.500  | 2.25 | .16      | 6.50     | 3/8-16 |
| 145T  | 3.50 | 2.75 | 5.00  | .34      | 7.45    | 7.75    | .8750  | 2.25 | 3/4   | 7.04     | 2.12 | 5.875  | 4.500  | 2.25 | .16      | 6.50     | 3/8-16 |
| 182   | 4.50 | 3.75 | 4.50  | .41      | 9.38    | 9.76    | .8750  | 2.25 | 3/4   | 8.08     | 2.12 | 5.875  | 4.500  | 2.75 | .16      | 6.50     | 3/8-16 |
| 184   | 4.50 | 3.75 | 5.50  | .41      | 9.38    | 9.76    | .8750  | 2.25 | 3/4   | 8.08     | 2.12 | 5.875  | 4.500  | 2.75 | .16      | 6.50     | 3/8-16 |
| 182T  | 4.50 | 3.75 | 4.50  | .41      | 9.38    | 9.76    | 1.1250 | 2.75 | 3/4   | 8.08     | 2.62 | 7.250  | 8.500  | 2.75 | .25      | 9.00     | 1/2-13 |
| 184T  | 4.50 | 3.75 | 5.50  | .41      | 9.38    | 9.76    | 1.1250 | 2.75 | 3/4   | 8.08     | 2.62 | 7.250  | 8.500  | 2.75 | .25      | 9.00     | 1/2-13 |
| 213   | 5.25 | 4.25 | 5.50  | .41      | 11.00   | 11.50   | 1.1250 | 3.00 | 1     | 9.31     | 2.75 | 7.250  | 8.500  | 3.50 | .25      | 9.00     | 1/2-13 |
| 215   | 5.25 | 4.25 | 7.00  | .41      | 11.00   | 11.50   | 1.1250 | 3.00 | 1     | 9.31     | 2.75 | 7.250  | 8.500  | 3.50 | .25      | 9.00     | 1/2-13 |
| 213T  | 5.25 | 4.25 | 5.50  | .41      | 11.00   | 11.50   | 1.3750 | 3.38 | 1     | 9.31     | 3.12 | 7.250  | 8.500  | 3.50 | .25      | 9.00     | 1/2-13 |
| 215T  | 5.25 | 4.25 | 7.00  | .41      | 11.00   | 11.50   | 1.3750 | 3.38 | 1     | 9.31     | 3.12 | 7.250  | 8.500  | 3.50 | .25      | 9.00     | 1/2-13 |
| 254U  | 6.25 | 5.00 | 8.25  | .53      | 14.09   | 14.27   | 1.3750 | 3.75 | 1-1/4 | 10.96    | 3.50 | 7.250  | 8.500  | 4.25 | .25      | 10.00    | 1/2-13 |
| 256U  | 6.25 | 5.00 | 10.00 | .53      | 14.09   | 14.27   | 1.3750 | 3.75 | 1-1/4 | 10.96    | 3.50 | 7.250  | 8.500  | 4.25 | .25      | 10.00    | 1/2-13 |
| 254T  | 6.25 | 5.00 | 8.25  | .53      | 14.09   | 14.27   | 1.625  | 4.00 | 1-1/4 | 10.96    | 3.75 | 7.250  | 8.500  | 4.25 | .25      | 10.00    | 1/2-13 |
| 256T  | 6.25 | 5.00 | 10.00 | .53      | 14.09   | 14.27   | 1.625  | 4.00 | 1-1/4 | 10.96    | 3.75 | 7.250  | 8.500  | 4.25 | .25      | 10.00    | 1/2-13 |
| 284U  | 7.00 | 5.50 | 9.50  | .53      | 14.94   | 15.88   | 1.625  | 4.88 | 1-1/2 | 13.19    | 4.62 | 9.000  | 10.500 | 4.75 | .25      | 11.25    | 1/2-13 |
| 286U  | 7.00 | 5.50 | 11.00 | .53      | 14.94   | 15.88   | 1.625  | 4.88 | 1-1/2 | 13.19    | 4.62 | 9.000  | 10.500 | 4.75 | .25      | 11.25    | 1/2-13 |
| 284T  | 7.00 | 5.50 | 9.50  | .53      | 14.94   | 15.88   | 1.875  | 4.62 | 1-1/2 | 13.19    | 4.38 | 9.000  | 10.500 | 4.75 | .25      | 11.25    | 1/2-13 |
| 286T  | 7.00 | 5.50 | 11.00 | .53      | 14.94   | 15.88   | 1.875  | 4.62 | 1-1/2 | 13.19    | 4.38 | 9.000  | 10.500 | 4.75 | .25      | 11.25    | 1/2-13 |
| 284TS | 7.00 | 5.50 | 9.50  | .53      | 14.94   | 15.88   | 1.625  | 3.25 | 1-1/2 | 13.19    | 3.00 | 9.000  | 10.500 | 4.75 | .25      | 11.25    | 1/2-13 |
| 286TS | 7.00 | 5.50 | 11.00 | .53      | 14.94   | 15.88   | 1.625  | 3.25 | 1-1/2 | 13.19    | 3.00 | 9.000  | 10.500 | 4.75 | .25      | 11.25    | 1/2-13 |
| 324U  | 8.00 | 6.25 | 10.50 | .66      | 15.93   | 15.88   | 1.875  | 5.62 | 2     | 13.69    | 5.38 | 11.000 | 12.500 | 5.25 | .25      | 14.00    | 5/8-11 |
| 326U  | 8.00 | 6.25 | 12.00 | .66      | 15.93   | 15.88   | 1.875  | 5.62 | 2     | 13.69    | 5.38 | 11.000 | 12.500 | 5.25 | .25      | 14.00    | 5/8-11 |
| 324T  | 8.00 | 6.25 | 10.50 | .66      | 15.93   | 15.88   | 2.125  | 5.25 | 2     | 13.69    | 5.00 | 11.000 | 12.500 | 5.25 | .25      | 14.00    | 5/8-11 |
| 326T  | 8.00 | 6.25 | 12.00 | .66      | 15.93   | 15.88   | 2.125  | 5.25 | 2     | 13.69    | 5.00 | 11.000 | 12.500 | 5.25 | .25      | 14.00    | 5/8-11 |
| 324TS | 8.00 | 6.25 | 10.50 | .66      | 15.93   | 15.88   | 1.875  | 3.75 | 2     | 13.69    | 3.50 | 11.000 | 12.500 | 5.25 | .25      | 14.00    | 5/8-11 |
| 326TS | 8.00 | 6.25 | 12.00 | .66      | 15.93   | 15.88   | 1.875  | 3.75 | 2     | 13.69    | 3.50 | 11.000 | 12.500 | 5.25 | .25      | 14.00    | 5/8-11 |
| 364U  | 9.00 | 7.00 | 11.25 | .66      | 19.00   | 20.00   | 2.125  | 6.38 | 2-1/2 | 17.88    | 6.12 | 11.000 | 12.500 | 5.88 | .25      | 14.00    | 5/8-11 |
| 365U  | 9.00 | 7.00 | 12.25 | .66      | 19.00   | 20.00   | 2.125  | 6.38 | 2-1/2 | 17.88    | 6.12 | 11.000 | 12.500 | 5.88 | .25      | 14.00    | 5/8-11 |
| 364T  | 9.00 | 7.00 | 11.25 | .66      | 19.00   | 20.00   | 2.375  | 5.88 | 2-1/2 | 17.88    | 5.62 | 11.000 | 12.500 | 5.88 | .25      | 14.00    | 5/8-11 |
| 365T  | 9.00 | 7.00 | 12.25 | .66      | 19.00   | 20.00   | 2.375  | 5.88 | 2-1/2 | 17.88    | 5.62 | 11.000 | 12.500 | 5.88 | .25      | 14.00    | 5/8-11 |
| 364TS | 9.00 | 7.00 | 11.25 | .66      | 19.00   | 20.00   | 1.875  | 3.75 | 2-1/2 | 17.88    | 3.50 | 11.000 | 12.500 | 5.88 | .25      | 14.00    | 5/8-11 |
| 365TS | 9.00 | 7.00 | 12.25 | .66      | 19.00   | 20.00   | 1.875  | 3.75 | 2-1/2 | 17.88    | 3.50 | 11.000 | 12.500 | 5.88 | .25      | 14.00    | 5/8-11 |

\*C DIMENSIONS ARE SHOWN ON MOTOR PAGES E-3 TO E-11.

**WARNING** FOR SAFETY AND TO COMPLY WITH LOCAL AND NATIONAL SAFETY CODES, THE PURCHASER OR USER MUST PROVIDE PROTECTIVE GUARDS OVER ALL SHAFT EXTENSIONS AND DEVICES MOUNTED THEREON.

Don't see the motor you need?  
Contact factory.  
Many more stock motors available.